

401-29-HSH

High-frequency spindle
Manual tool change

Spindle for high-speed milling, -grinding, -
drilling, -engraving

Technical specifications

- High precision steel ball bearings – 2 Pcs.
- Lifetime lubricated, maintenance free
- Motor: type 0
- Nominal output power: max. 0,17 kW
- Current voltage: max. 36 V
- Current: max. 7 A
- Frequency: max. 833 Hz
- Motor poles: 1 pair
- Rotation speed: max. 50.000 rpm
- Housing diameter: 29 mm
- Cooling system: air cooled
- Tool change: Manual tool change
- Clamping range: up to 4,0 mm
- Coupler plug: 3-pole plastics
- Weight: 0,38 Kg

Dimensions

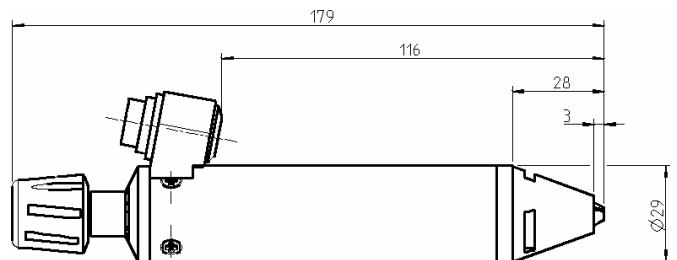

Power-, torque- and speed diagram

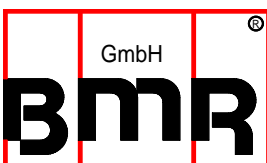
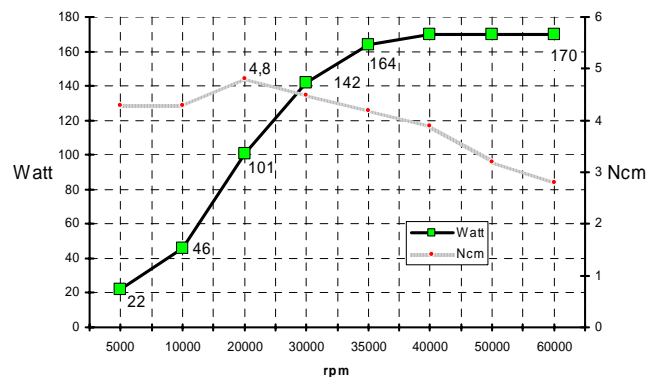

BMR GmbH • elektrischer & elektronischer Gerätebau
Unterreichenbacher Straße 1 • D-90455 Nürnberg-Katzwang
Tel. +49 (0)9122-631480 • Fax + 49 (0)9122-6314829
info@bmr-gmbh.de www.bmr-gmbh.de